

 CLAROFLEX®

Claroflex **Slide 2020**



USER MANUAL AND WARRANTY

0. INDEX

1. General information	3
1.1. Recommendations	3
1.2. Product identification	3
1.3. Installation completion form	3
2. Limits of use	4
2.1. Intended use of the system	4
2.2. Installation zone	4
2.3. User requirements	4
3. Technical description	4
3.1. Mechanical components	4
4. Packaging, handling and shipping (Distributor/Installer)	5
5. Installation (Distributor/Installer)	6
5.1. Slide system installation	6
6. Operating instructions	7
6.1. Opening instructions	7
7. Waste disposal (Distributor/Installer)	9
8. Maintenance	9
9. Possible problems and solutions	10
10. Exploded view of the system	11
11. Technical table	12
12. Warranty	12
12.1. Warranty period	12
12.2. Range	12
12.3. Exclusions	13
12.4. Customer's responsibilities (Distributor/Installer)	13
12.5. Returns policy (Distributor/Installer)	14
Annex 1 - Installation completion form	15
Annex 2 - CE Certificate of compliance	16

1. GENERAL INFORMATION

1.1. Recommendations.

PLEASE READ CAREFULLY ALL WARNINGS AND INSTRUCTIONS IN THIS DOCUMENT.

This manual is considered an important part of the product. Please keep it in good condition and available for future consultation.

In this booklet, you will find all the instructions to use the system correctly, avoiding injuries and damages to the product.

For general questions or in the event of unforeseen situations, please contact your system's manufacturer.

Distribuidora de Sistemas de Cierre S.L. reserves all rights related to this manual. Any reproduction (total or partial) of any elements mentioned here, is strictly forbidden without written consent.

Only authorized and qualified personnel must carry out the installation of the system, following the steps in the machining and installation guides.

Any alteration or modification made to the product without the manufacturer's authorization exempts the manufacturer from any liability for the damages that may be caused.

1.2. Product identification.

Information about the CE Certificate of compliance can be found in Annex 2 of this booklet.



Claroflex® Slide system

Frameless aluminium glazing system.

1.3. Installation completion form.

The document with information about your Claroflex® Slide 2020 system can be found in Annex 1 of this booklet. Your installer should fill it in.

2. LIMITS OF USE

2.1. Intended use of the system.

This instructions manual is directed towards anyone making use of the system, such as installers, owners or end-users.

This system has been designed and manufactured exclusively as a glazing system for public and residential buildings.

The system should only be used in these settings.

Any other use is considered improper and exempts the manufacturer from any liability for the personal or material damages that may be caused as a result.

Failure to comply with the terms of use automatically voids any warranty given by the manufacturer.

2.2. Installation zone.

The Claroflex Slide system has been designed and manufactured to be used inside and out.

Make sure there aren't any objects in the path of the panels or the person operating the system before use.

2.3. User requirements.

The system should not be operated by minors.

The installation and adjustment of the system must be performed by authorized and qualified personnel only.

3. TECHNICAL DESCRIPTION

3.1. Mecanical components.

- **Extruded anti-corrosion** (UNE EN 755) aluminium powder-coated or anodised **profiles**.
- **Tempered or laminated glass** (following local guidelines).
- Stainless steel **lock** or **latch**.
- ZAMAK **End caps** with anti-corrosion coating.
- Steel / stainless steel and polyamide **roller sets**.
- PVC **sealing strips** and **gaskets**.
- A2 stainless steel **screws**.
- POM **panel blockers**.

4. PACKAGING, HANDLING AND SHIPPING

(Distributor/Installer)

Follow applicable safety guidelines at all times when handling and transporting components to guarantee they arrive in perfect condition.

Avoid contact between aluminium parts and with abrasive products to stop paint damage.

When storing and transporting glass, use rubber pads or similar to avoid scratches or breakages.

All goods must be secured with straps or similar during shipping.

Any objects that are longer than 2 m or weigh more than 35 kg must be handled between two people.

Caution: Do not leave packaging within the reach of children.

To maintain the right to raise warranty claims on the products supplied by CLAROFLEX® all packages and components must be checked within 24h of receiving the order to identify any damage that may have occurred during the transportation of the goods.

5. INSTALLATION

(Distributor/Installer)

Only authorized and qualified personnel can carry out the installation of the system, following the steps in the installation guide and all safety guidelines.

When working in a team, one installer must be assigned as project manager.

All installers must comply with all safety instructions they are given.

If a system needs to be installed at a height, the area under the structure must be cordoned off to make sure nobody is under any hanging loads.

Secure all suspended loads correctly to avoid falls.

5.1. Slide system installation.

Read the installation instructions carefully to avoid risk of damage, falls, ect.

Check the condition of the area the system will be installed in before securing it. If the area does not comply with the minimum standards necessary, structural profiles can be used.

To download the installation manual, use this link:

<http://www.claroflex.com/en/soporte/>

Caution: Please remember that systems that are not installed correctly could cause personal injuries.

6. OPERATING INSTRUCTIONS

Caution: Before operating the system, make sure that there are no objects or persons obstructing the path of the panels.

Do not force the system components at any time. In case of malfunction, contact your nearest dealer. Please make sure that only genuine Claroflex® components are used if a replacement part is needed.

Genuine Claroflex® parts are stamped with the logo and the manufacturer's mark.

6.1. Opening instructions.

Open the system starting with the first panel, following the instructions that apply to the type of system you have.

Do not move the panels in an abrupt manner, forcing the parts unnecessarily.

The number of panels or guide rails does not affect the operating instructions.

Some opening examples:

a. - Standard system, double U profile and latch. Side opening.

To open the system, unlock the lower latch and then drag the first panel in the opening direction using the handle or lock. The rest of the panels will be dragged by the first one until the system is completely open.

To close the system, push the first panel carefully to the opposite end of the system. The other panels will be dragged by the first.

To activate or deactivate the latch, push the knob upwards or downwards.

Please open and close the system slowly, taking into account the inertia of the panels in movement.

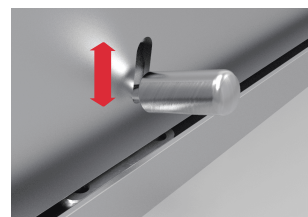
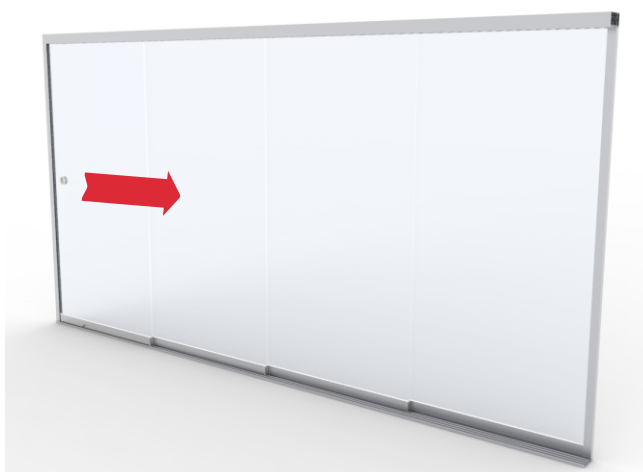

6. OPERATING INSTRUCTIONS

b.- System with standard lock and side opening.

Following the instructions shown, turn the lock or key and push the lock plate to open the first panel.

Push the first panel in the opening direction until the system is completely open. To close, follow the same steps in the opposite order, slide the panels with care until the system is closed. Please try to avoid abrupt collisions between one panel and the next.

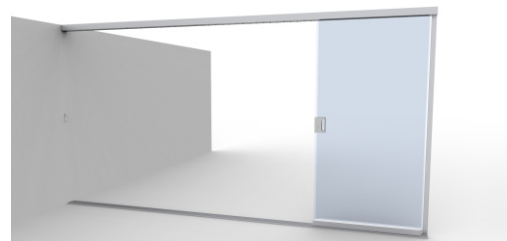
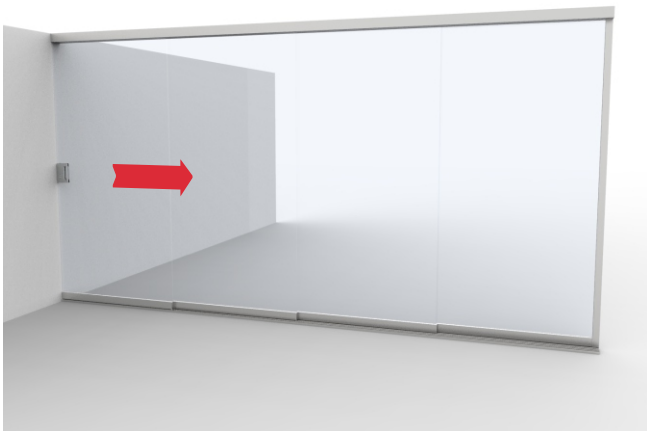

c.- System with lock and strike, central opening.

Follow the instructions in the images according to the type of lock installed. In this case, slide the lock panel to one side and the latch panel to the opposite side. To open the system, push the panel with the lock so it drags the rest of the panels to the other end. Do the same for the other side of the system.

Follow these steps in the opposite order to close the system. Pay special attention to the contact between the panels and close the system with a smooth controlled movement.



7. WASTE DISPOSAL

(Distributor/Installer)

Caution: The system must be dismantled following the same safety instructions used for the installation (see chapter 5) by a qualified person.

All waste must be taken to a waste collection plant to be correctly disposed of.

All components and their composition are listed in chapter 3 of this booklet.

Check local guidelines on waste disposal before taking disassembly.

8. MAINTENANCE

Caution: All additional maintenance and repair operations must be performed by qualified staff, which may require the intervention of a CLAROFLEX specialist.

Due to the high quality of the materials used, the system does not require any special maintenance.

The glass can simply be clean with a damp cloth and window cleaner. Avoid using solvent, ammonia, hydrocarbons, etc. as these products can be abrasive.

Warning: Cleaning and maintenance tasks that require the use of scaffolds, ladders or hazardous materials should be performed by trained staff following all applicable safety regulations and using the appropriate safety equipment to prevent injuries.

9. POSSIBLE PROBLEMS AND SOLUTIONS

During troubleshooting procedures, all safety requirements must be adhered to at all times.

The table below shows information on possible problems that may arise, along with their solutions that can be performed easily.

In the event that the problem cannot be solved with the information provided, please contact your installer.

Warning: Please follow the steps provided, any other modifications to the systems could make the warranty void.

Problem	Possible cause	Solution
Difficulty moving panels	Objects or dirt on the guide rails are obstructing the panels.	Check and clean the guide rails thoroughly.
The fixed panel moves	The panel stopper has been dislodged.	Reinstall the panel blocker (located in the top track) by positioning it touching the panel that should be fixed. Use a 3 mm hex key to do so.
Noise between the sealing strips	The tempered glass is curved.	Place all the panels with the curve facing the same side.

10. EXPLODED VIEW OF THE SYSTEM

N°	Reference	Name
1	CRDA201	Bottom track
2	CRDA202	Bottom track extension
3	CRDA203	Top track
4	CRDA204	Top track extension
5	CRDA205	Panel profile
6	CRDA006	Slide U profile
7	CRD006/N	Roller set
8	CRD0097	Brush seal
9	CRD010/12 18/210/310	Strips

N°	Reference	Name
10	CRD013/ 141/142	Gasket
11	CRD025/ 26/27/28	Flush handle
12	CRD079	Latch
13	CRD083	Latch strike
14	CRD207	Simple end cap
15	CRD208	Drag cap
16	CRD216	Panel stopper
17	CRD217	Tamper-proof stopper

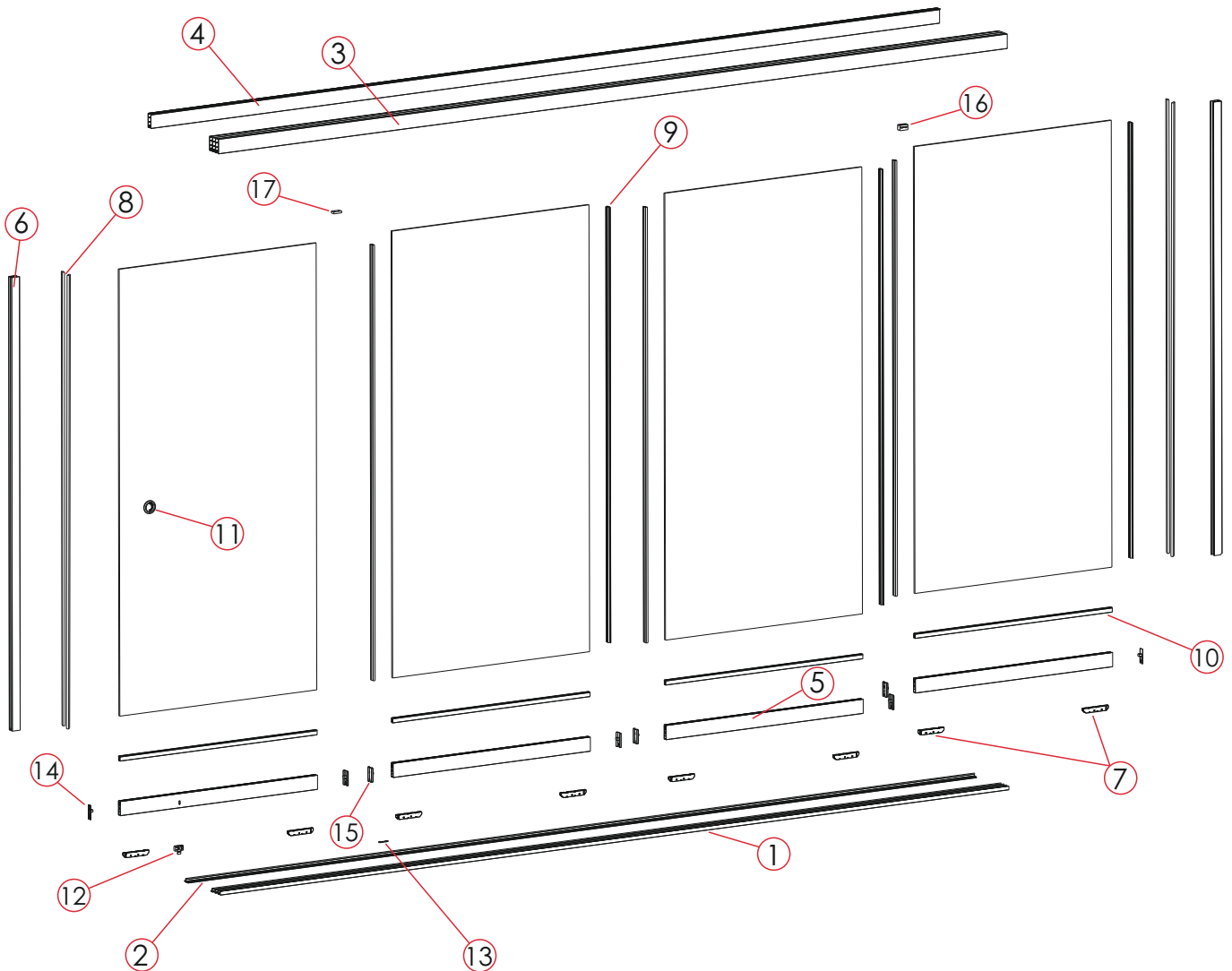

11. TECHNICAL TABLE

Aproximate weight (in Kg) **of the system**, for three tracks and 10 mm glass.

Width (mm) \ Height (mm)	1000	1500	2000	2500	3000	3500	4000	4500	5000	5500	6000	6500
1000	27	40	54	67	81	94	107	121	134	148	161	175
1500	39	59	79	98	118	138	157	177	197	216	236	256
2000	52	78	104	130	156	182	259	233	259	285	311	337
2500	64	97	129	161	193	225	322	290	322	354	386	418
3000	77	115	154	192	231	269	384	346	384	423	461	500

These values must be taken into account when the structural resistance of the bottom support is estimated.

12. WARRANTY

All products from Distribuidora de Sistemas de Cierre, S.L., are registered under the brand CLAROFLEX®. These products are made to measure exclusively for each project, so no "standard measurements" or stock of finished products are kept.

12.1. Warranty period.

Distribuidora de Sistemas de Cierre, S.L. guarantees its products for a period of 5 years from the manufacture date.

12.2. Range.

The manufacturer's warranty covers the repair or replacement of all defective parts as per the applicable regulations.

The warranty only comes into effect when the system has been installed by an official CLAROFLEX® distributor following the contractual documents and good manufacturing practice.

12. WARRANTY

12.3. Exclusions.

Warranty does not cover damage to glass and plastic components unless there is evidence of defects in materials or workmanship.

IMPORTANT NOTICE

Painted profiles: If exposed to a very salty environment, aluminium profiles that have been painted can peel or bubbles can appear. These conditions are not included in the warranty.

Anodised profiles: Claims for damaged anodised profiles will not be accepted unless the client sends a sample of the damage for it to be looked at.

Painted bottom tracks: The warranty does not cover any imperfections or damage in the paint as a result of use.

Seal strips: With time the seal strips can decolour, these components are not included in the warranty.

Other exclusions:

- Defects caused by misuse or vandalism
- Adjustments, repairs, and replacements due to normal fatigue, careless use of the product, or failure to follow the instructions contained in this manual.
- Damage caused by structural failure, excessive deflection, or due to factors beyond the control of the manufacturer including acts of nature.
- Modifications, repairs, and new installations made without the approval of the manufacturer or distributor/installer.
- Blinds or other accessories or complimentary structures.
- Expenses incurred from dismantling, replacing, etc. broken or damaged products and components.
- Failures, breakages and damage caused by improper use or installation of Distribuidora de Sistemas de Cierre, S.L. (CLAROFLEX[®]) products by installers, users or third parties).

12.4. Customer's Responsibilities (Distributor/Installer).

It is the customer's responsibility to verify & check the perfect conditions of the goods received. The client has a maximum of 24h from reception to review & check each and every one of the packages received.

Any discrepancies should be reported immediately to **Distribuidora de Sistemas de Cierre, S.L.** . In addition, a written claim must be sent to the transport agency and copy to **Distribuidora de Sistemas de Cierre, S.L.** with all necessary information: photos of the products and their packaging, the delivery note, etc.

12. WARRANTY

12.5. Returns policy (Distributor/Installer).

For all returns **Distribuidora de Sistemas de Cierre, S.L.** must be informed in writing (by fax or email) before sending anything.

Please include a list of all components that you wish to return, along with the reasons for the return and the delivery note or invoice number.

Distribuidora de Sistemas de Cierre, S.L. will study all requests to return products and will inform in writing the necessary preparations for shipping.

INSTALLATION COMPLETION FORM

Product reference:

General dimensions:

System details:

Name and signature
or stamp:
(Installer)

Additional notes:

Inspection history

Date	Description of tasks	Installers details



CE CERTIFICATE OF COMPLIANCE Ed.1
(Under the CE Product Directives of construction 89/106/CEE)

MANUFACTURER: DISTRIBUIDORA DE SISTEMAS DE CIERRE S. L.
Glorieta Plácido Fernández Viagas,
Carretera de Cártama, Km 11,4
29590 Málaga, España

PRODUCT: FRAMELESS GLAZING SYSTEM.
CLAROFLEX SLIDE SYSTEM

Declares that, the product mentioned, it has been developed and manufactured under regulation of directive 89/106/CEE **PRODUCTS FOR CONSTRUCTION** and complies with the specifications from the appendix of the standards:

UNE EN 12211:2017 Building enclosures and their hardware, as per the following features:

Model – Series	Claroflex Slide
Material	Aluminium
Glazing	10 mm Monolithic Tempered Glass
Wind Resistance	Class 6
Hazardous Substances	Comply with present statutory regulations
Date of test	23/11/2017

Type test made by the Laboratory nº 1668 ENSATEC, S. L.,
Polígono Lentiscareas – Avda. Lentiscareas, nº 4-6, Navarrete (La Rioja), Spain.

The following standards test have been follow:

- UNE-EN 1932:2014. Resistance to wind loads.
- UNE-EN 13659:2016. Performance requirements included the security.
- UNE-EN 13561:2015. External blinds and awnings. Performance requirements including safety.

DISTRIBUIDORA DE SISTEMAS DE CIERRE, S. L., is only responsible with this Certificate of Compliance for the products provided by our Company, and produced/fabricated under our technical specifications and procedures.

Francisco Javier Oña González



Administrator

Cártama, November 23, 2017

**DISTRIBUIDORA DE
SISTEMAS DE CIERRE, S.L.**
B 93405496